

Ferry County Out Building Application

- | | |
|---|--------|
| 1. Will the building be larger than 1000 square feet? | Yes No |
| 2. Will the building have eave projections greater than 2 feet? | Yes No |
| 3. Will the building be greater than one story in height? | Yes No |
| 4. Will the building be closer than 20 feet to a property line or other building? | Yes No |
| 5. Will the building be closer than the height of the building plus 5 feet, to a property line or other building? | Yes No |
| 6. Is there drainage plumbing in the building? | Yes No |
| 7. Is there hot water supply plumbing in the building? | Yes No |
| 8. Will the building be a place of human habitation? | Yes No |
| 9. Will the building be a place of employment? | Yes No |
| 10. Will the building be used by the public? | Yes No |
| 11. Is there a residential structure on the property or on contiguous property? | Yes No |

If you answered no to the first ten questions, and yes to the last question, you have the option of either obtaining a Building Permit, or a Partial Exemption Building Permit. **(If you answered yes to any of the first ten questions, or no to the last question, you must obtain a Building Permit, rather than a Partial Exemption Building Permit. If you are adding to an existing building, you do not qualify for a partial exemption.)**

In order to obtain a Building permit, you must submit construction plans. A plan review will be performed, inspections will be made, and the fee will be calculated based on the square footage of the structure. If you elect to obtain a Partial Exemption Permit, no plan review or inspections will be made. The only plan required to obtain a Partial Exemption Permit is an accurate plot plan. **The plot plan must show the location of the proposed building in relation to other structures and property lines.**

The fee for a Partial Exemption Permit is \$35.00. We also offer an optional Plan Review service. (Inspections will not be made, but you can verify that the materials you decide to use will meet code.) The fee for the plan review is \$30.00. Partial Exemptions are subject to all Planning Land Use Regulations. If it becomes necessary to make a site visit, a \$30.00 site visit fee will be charged.

All fees can be made payable to the Ferry County Planning Department.

Please circle a choice below:

- Partial Exemption (Flat fee of \$35.00) **See above 11 questions.**
- Building Permit (Fee determined based on sq. footage, and no additional fees are collected. Plan review and shoreline staking are included in the permit fee.)

OUT BUILDING

FERRY COUNTY BUILDING PERMIT CHECKLIST

1. Is there any water: river, creek, lake, pond, or wetland (circle all that apply), on or near your property?
If yes, what is the distance between the building site and the water? _____
2. Are you planning to move over 500 cubic yards (50 dump truck loads) during building? (circle one) Yes -- No
3. Are you planning to move over 250 cubic yards (25 dump truck loads) during building? (circle one) Yes -- No
4. What is the size of your property? _____
5. Will proposed building have plumbing? (circle one) Yes -- No
6. Will you be building yourself or hiring a contractor? (circle one)

A COPY OF THE CONTRACTOR'S CURRENT LICENSE MUST BE PROVIDED TO THE PLANNING DEPARTMENT BEFORE A BUILDING PERMIT WILL BE ISSUED.

7. Have you applied for a road approach permit? (circle one) Yes -- No -- N/A
8. What is your physical address? _____
If you do not have a physical address, please apply for one at the 911 Office in the Sheriff's Department.
10. Do you have any easements or right-of-ways on your property? (circle one) Yes -- No
It is the landowner's responsibility not to encroach on any easements or right-of-ways.
11. Is the property within the jurisdiction of other agencies or a Home Owner's Association? (circle one) Yes -- No
If yes, it is the responsibility of the applicant to acquire said permit(s), and to comply with all applicable rules, regulations, ordinances, and/or restrictive covenants of those jurisdictions.

NAME: _____ PHONE: _____



Ferry County
PLANNING DEPARTMENT
 Post Office Box 305
 Republic, WA 99166
 Phone: (509) 775-5225 Ext 3101
 FAX: (509) 775-5240

A permit will NOT be issued until all questions are answered
 And requirements are met. An accurate plot plan must be
 submitted before a permit can be issued.

Property Owner _____

Mailing Address _____

City _____

State, Zip _____

Phone _____

Tax Parcel # _____

Contractor _____

Contractor Street Address _____

Contractor City, State, Zip _____

License # _____

Contractor Phone _____

Describe fully the intended use of the structure:

Proposed Start Date _____

Septic Permit # _____

Permit becomes VOID if construction has not started within
 12 months of issuance OR if work is suspended for more
 than 180 days, unless a written request for an extension is
 received.

**I certify that I have read and understand this application
 and know the same to be true and correct. All
 provisions or laws and ordinances governing this type
 of work will be complied with whether specified herein
 or not.**

Owner Signature _____

Agent's Signature _____

OUTBUILDING BUILDING PERMIT APPLICATION

Directions to job site and physical address:

Shoreline Permits may be required for projects when located
 200 feet landward of a protected shoreline. Structures
 located in the 100-year flood plain are subject to the Flood
 Damage Prevention Ordinance and must have a flood area
 compliance endorsement. Issuance of a building permit
 does not exempt these or any other ordinances when
 applicable.

OFFICE USE ONLY

Dimensions Sq. Feet Cost per Valuation

Garage _____ x _____ = _____ x _____ = _____

Carport _____ x _____ = _____ x _____ = _____

Deck _____ x _____ = _____ x _____ = _____

Foundation--Linear Feet _____ x _____ = _____

Slab _____ x _____ = _____ x _____ = _____

Out- _____ x _____ = _____ x _____ = _____
 building

Other _____ x _____ = _____ x _____ = _____

Total Square Footage = _____

Total Value = \$ _____

Permit Fee = \$ _____

State Building Code Fee = \$ _____

Date & Received by _____ Total Fee = \$ _____

Permit # _____

Date Issued _____

Valuation _____

THIS PAGE WAS LEFT BLANK INTENTIONALLY

sample plot plan

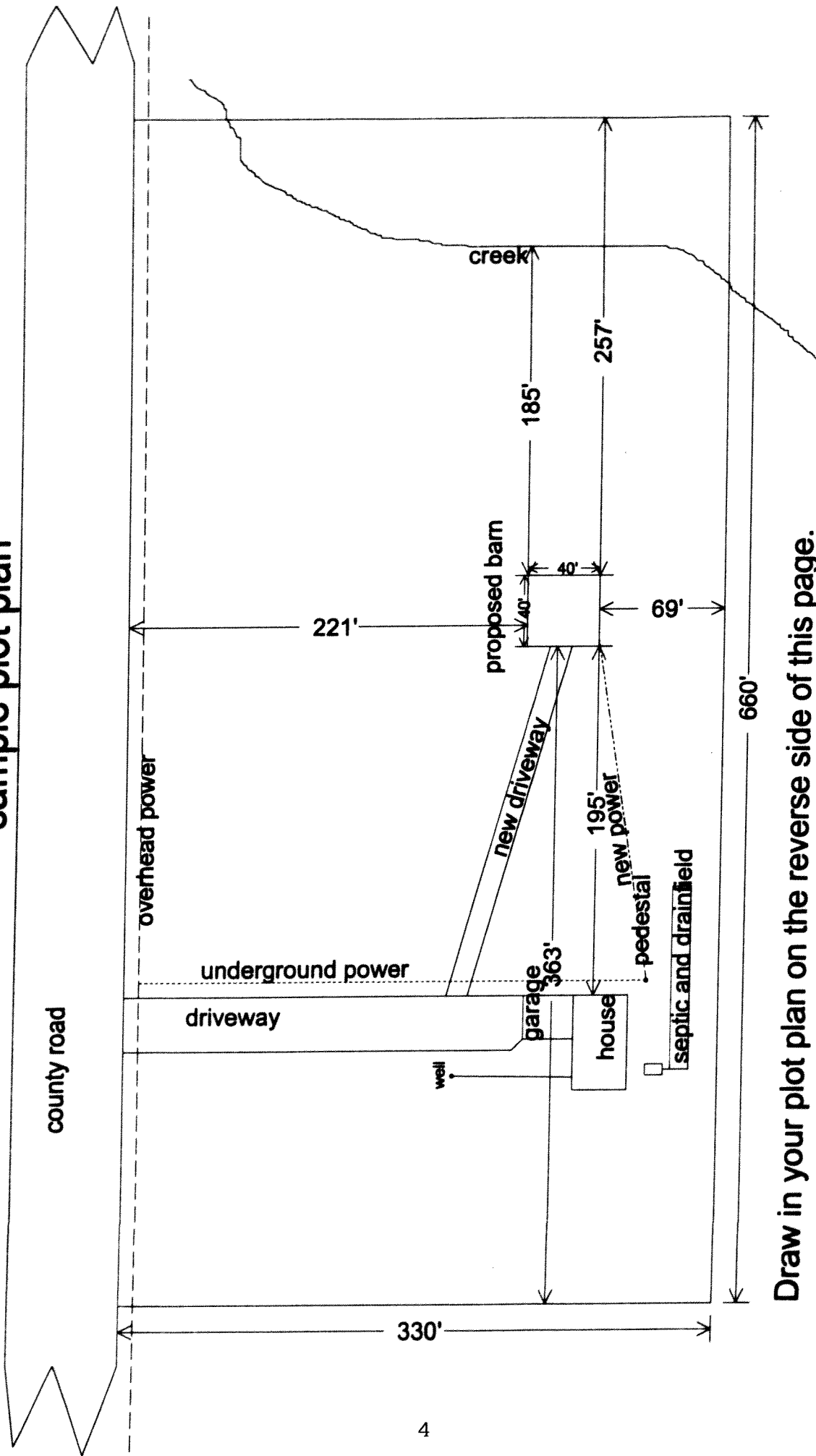

Draw in your plot plan on the reverse side of this page.

Plot Plan

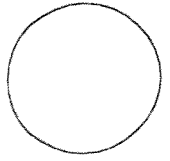

show direction of north in circle

A large, empty rectangular box with a black border, occupying most of the page. It is intended for drawing a plot plan.